

BUTTERFLY VALVE PN 40

LEHRY MAKE Butterfly valves are most suitable for wide range of industrial applications. These Valves can be integrated with a consistent range of actuators to create complete flow control packages. Versatile ranges of resilient seated quarter turn butterfly valves are available in various configuration and materials to match critical applications. Higher end quality inspection ensures 100% compliance of safety measures, specified pressure rating and each valve assures tight shut-off.

Features :-

- ❖ No pins between shaft and disk connection; this eliminates the possibility of electrolytic corrosion
- ❖ Self lubricated plain bearings for both drive and non-drive end shaft ensures minimum bearing friction torque
- ❖ Choice of seat and disc material to suit media and service requirements
- ❖ Adaptability to lift between companion flanges for all popular flanges standards for wafer style body
- ❖ Excellent adaptability for actuator operation through standardized **ISO 5211** flange mounting dimensions for actuator fitment.

APPLICATIONS

- ❖ General Circuit water, Fuel, Oil, Gas industries
- ❖ Flow Shut Off or Regulating Function in sectors including water supply of Sewage, Irrigation, HVAC, Fire Fighting

Specification :-

Body	WCB / CF8 / CF8M
Disc	ASTM A 351 Gr. CF8 / CF8M
Seat	PTFE Graphite Filled PTFE Glass Filled PTFE
Mfg STD	API 609
Insp & Test STD	API 598
Shaft	AISI 410 / AISI 304 / AISI 316
Ends	Wafer Type to Suit ASME B 16.5 300#
Operation	Flow Control Lever / Gear / Pneumatic
End Connection	Wafer Type
Pressure Rating	PN 40
Hyd. Test Pressure	Body : 79 Kg/Cm ²
	Seat : 57 Kg/Cm ²

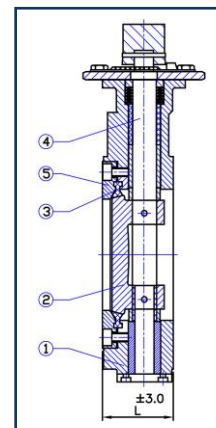
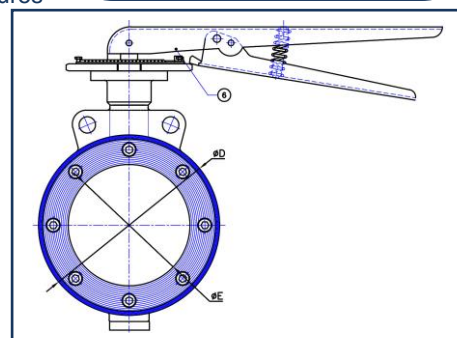

Dimensions

(All Dimensions are in mm)

Size	INCHES	1 1/2	2	2 1/2	3	4	5	6	8	10	12	14	16	18	20	24
	MM	40	50	65	80	100	125	150	200	250	300	350	400	450	500	600
L		42	45	48	48	54	59	59	64	87	92	117	133	149	159	181
ØE		38	51	61	72	100	123	143	192	239	290	335	388	425	475	560
ØD		82	101	108	127	159	187	219	270	340	394	436	500	540	595	705

DATA TO BE SUPPLIED WHILE ENQUIRY

- ❖ Size
- ❖ Actuation
- ❖ Nature of Fluid
- ❖ Flow Temperature
- ❖ Connection
- ❖ Working Condition
- ❖ Flow Pressure

Lehry Instrumentation & Valves Pvt. Ltd.,

"Lehry Chambers" #78 (Old No: 51) Sembudoss Street,
P.B No.1506, Parrys, Chennai - 600 001.
Phone : 044 25226995/25225185/25226187/42163823/
42625620/42625621. Fax : 044 25231715
Email : info@lehry.com / Website : www.lehryvalves.com
Branches : Chennai, Bangalore, Hyderabad, Mumbai, Noida, Pune